

Introducing the dormakaba Axessor Apexx IP

Where Security Meets Convenience

Modernized Safe Lock family that allows for remote and centralized code lock management across your bank branch

Tired of having to track safe codes, adding users, deleting users, inability to change security parameters?

- The Axessor Apexx IP allows for near real time changes within your infrastructure modernizing how the market interacts with a safe lock, delivering a more cost effective and secure solution



IP Environment:		Current Standalone Environment:	
	Time Lock		IP Connectivity, Up to 16 Locks Per Keypad
	Time Delay		Remote Audit
	Time Lockout Schedule		1,000 Users Per Lock
	Remote Enable/Disable		Business Intelligence Hub: Active Alerts & Exception/ Scheduled Reporting
			Code Sharing A/B Codes
			Recording Codes Manually
			Security Personnel or Locksmiths Deployed to Change Codes
			Inability to Swiftly Alter Codes or Security Settings for Employee Turnover or Changing Security Parameters

Axessor Apexx

The New Standard in Safe Locks



Managing Safe Locks with Unprecedented Ease

The Axessor Apexx multi-lock IP platform allows you to *remotely and securely* manage an entire fleet of locks.

Through the most secure encryption, with Axessor Apexx you can remotely:

- Add or delete users
- Receive near real-time audits
- View lock user directory
- Apply security settings
- Receive active alerts

Industry Leading Security

From the leaders in safe locks and the most trusted brands, Cencon, Auditcon, LA GARD and Axessor, comes the new standard in safe locks for cash and asset security — Axessor Apexx.

We've met the unrivaled challenge of delivering the efficiency and convenience of a networked solution, while maintaining the highest security standards. Key security features include:

- Advanced security encryption
 - TLS 1.2 network encryption
 - AES256 lock to keypad encryption
- Receive active alerts
- Remotely set security parameters

Unmatched Convenience

Banks and retailers commonly use stand-alone locks to secure cash and assets. Stand-alone locks are costly and inefficient since they can only be configured, changed or audited manually at the keypad. Today's banking and retail markets demand more efficient solutions, which Axessor Apexx delivers, allowing you to remotely:

- Add, delete and modify user access to any lock across sites
- Easily accommodate floating personnel
- Receive audits from the lock in near real-time
- View active directory across all locks and sites

Substantial Cost Savings

As a long-standing industry partner, dormakaba understands the requirement that real value and savings drive the broad-scale adoption of new technologies. We designed Axessor Apexx to deliver a solid ROI, allowing you to:

- Eliminate costly service charges for:
 - Code changes
 - Audit data pulls
- Limit delays in managing users and audits
- Mitigate loss risk by receiving timely alerts

Apexx Architecture & Workflow

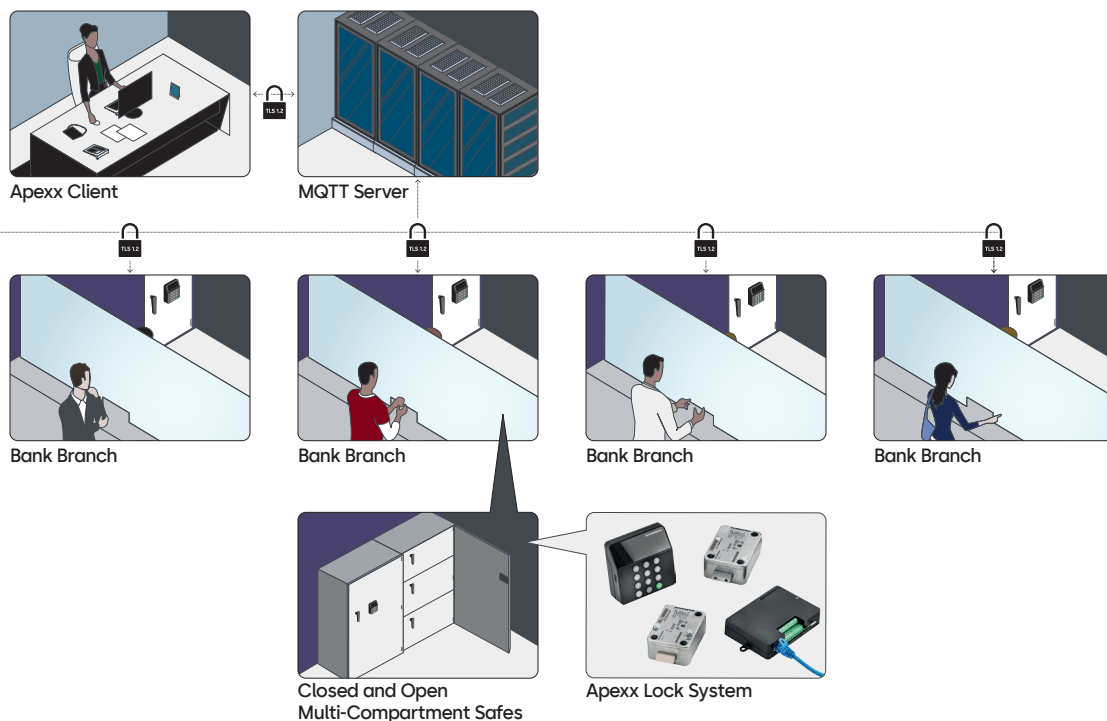

Network & Encryption	<ul style="list-style-type: none"> • HTTPS Protocol TLS 1.2 for ethernet connection • Key exchange by ECDSA 256 bit for CAN bus • Data transfer symmetric encryption AES256 • Built on RESTful API for simplified integration into company software systems
Software System Requirements	<ul style="list-style-type: none"> • Installation on your secure network or Windows (10/11) • SQL 19
Display	Backlit, OLED Display, Icon driven UI, BLE/RFID ready option
Lock Options	Motorized deadbolt and latch bolt options
Multi Lock Capacity	Up to 16 locks, 2 keypad, and a single eBox per lock system
User Capacity	Up to 1000 users per lock system
Power Management	AC line and POE options available; battery backup; USB-C emergency power
Lock System Features	Combo length: 1-10 ID + 6-12 PIN, duress alarm, programmable time lock, dual user mode (override), time delay (override), sequential open (multi-lock), and wrong try penalty
Audit Data	<ul style="list-style-type: none"> • Automatically pushed to software on near real-time basis • Downloadable to CSV or PDF
Automated Alerts	<ul style="list-style-type: none"> • Set in software, options include: duress, door open, immediate time lock • More available with API integration
Software Enabled Special Security Settings	Holiday schedules, lockout schedules, dual mode activation, opening and duress time delays
Active Directory	Dynamically maintained in Apexx Series Software



*Pending

Any questions? We would be happy to advise you.

TSN (TITAN) PTE LTD

1 Scotts Road, #24-10

Shaw Center

Singapore 228208

Fax: +65 6323 1839

Phone: +65 9117 1383

Email: admin@tsntitan.com